



Lock Better. Live Better.

User Manual

Smart Dead Lock



Special Attention:



1. Mechanical keys please keep outdoor, just in case keys lock in doors.
2. Please replace for the battery when low wattage alarm.
3. Reading this manual carefully before installation, and keep it for future reference.

1. Introduction

1.1. Lock structure

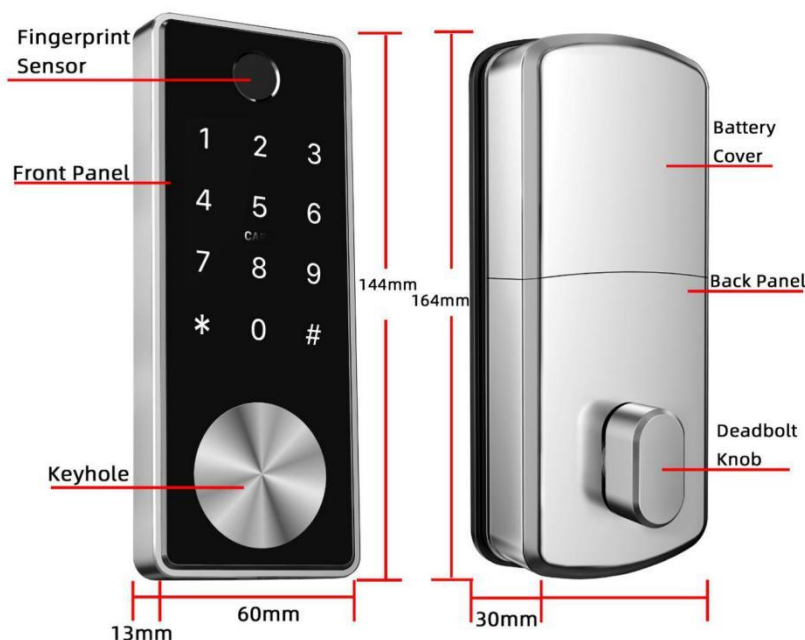

1.2. Packing List



Check the following drawing to check whether the package contains all the parts

NO	Name	Qty	NO	Name	Qty
1	Front Panel	1	9	Screw Stubs:M4*30mm	3
2	Back Panel	1	10	Screw Stubs:M4*40mm	3
3	Mortise	1	11	Mortise Screws:M4*25mm (For Wooden Door)	4
4	Card	3	12	Mortise Screws:M5*10mm (For Aluminum Door)	4
5	Mechanical Key	2	13	M4*10mm Screws For Fixing Back Panel	4
6	Waterproof Rubber Plate	2	14	M4*30mm Screw	3
7	User Manual	1	15	M4*50mm Screw	3
8	Strike&Strike Box	1+1	16	Sucker	1

1.3. Specifications

Suitable for Models	T11	Doors Applicable	Aluminum door Wooden door
Materials	Handle: Zinc Alloy	Working Voltage	6V/4x AA Batteries
Lock Weight	2.0KG	Door Thickness to Fit	35-60mm
Unlocking Way	Bluetooth Fingerprint(option) Password Card Mechanical key	Data Capacity	Fingerprint: 200 Password: 150 Card: 200
Color	Silver Black	Working Temperature	-10°C-55°C
Low Wattage Alarm	Less than 4.8V	Working Humidity	0-95%

1.4. Initialization

Long press the reset button on the back of the front panel for about 3s, input “000#”, the initialization is successful when the buzzer short beep twice.



Reset Button











Tip: How to open the key cover?



Use a suction cup to suck on the key cover for easier opening

2.Installation

2.1Confirm opening direction

Set The Left Open		Set The Right Open	
1			Spindle always keep horizontal
2			Deadbolt always keep pull in
3			What is left open? This we called "left open"(show as image)
4			Change to "L" or "R" position in the PCB of back panel
5			Deadbolt knob
Attention: Any of above is improper set, will cause problem ! ! !			

2.2. Installation Diagram

Step1 Install Mortise	Step2 Install Screws Casing and Water Rubber Plate
-----------------------	--

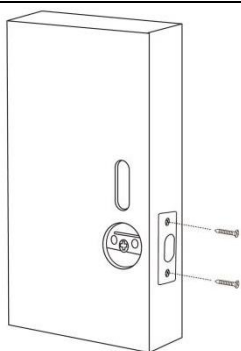

Step3 Install Front Panel

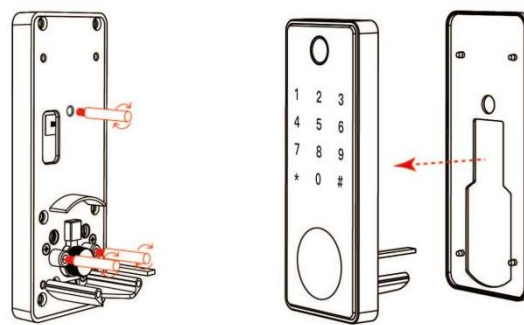

Step4 Fixed Front Panel and Water Rubber Plate

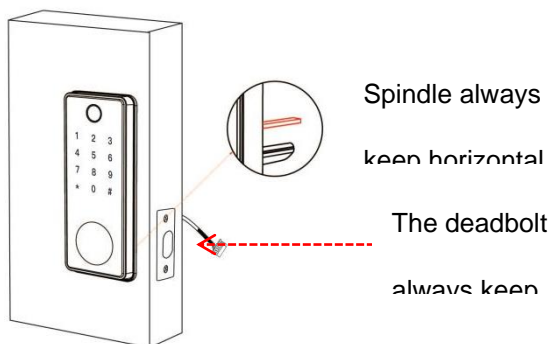

Step5 Connecting Front and Back Panels

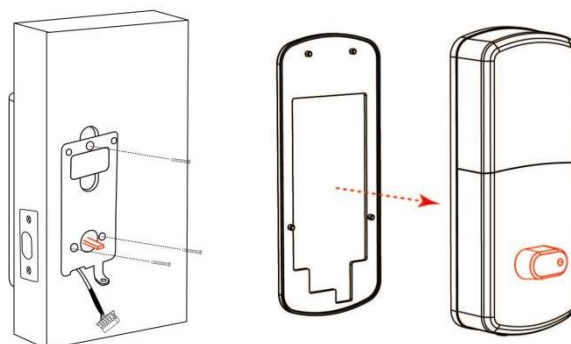

Step6 Fixed Back Panel

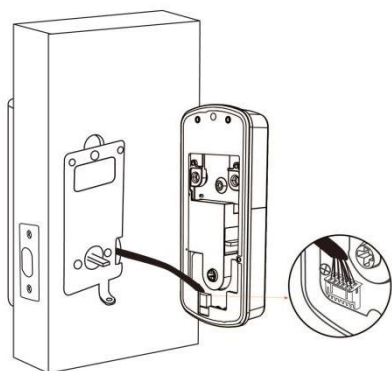

Step7 Install Batteries

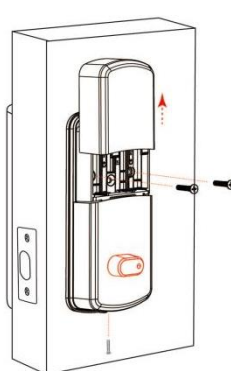

Step8 Cover the battery box

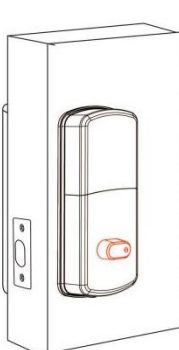
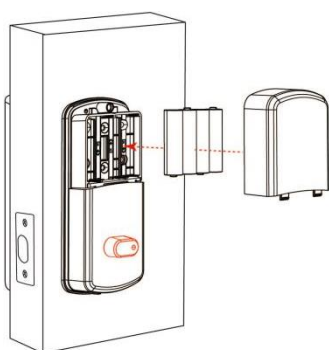

3.Operation

3.1. Registration



The app can be downloaded from the Google Play store, and the app can be downloaded from the application store (Qingyongbao, Baidu, Huawei, and Xiaomi).

3.2. Connect lock to the phone

- 1) please scan the QR code to download the app
- 2) You can also search for AUSLOCK in the APP store (Google Play) to download
- 4) Register a new account (phone number or email) or login with an existing account.
- 5) Touch the lock screen to light, click "+ Add Lock"
- 6) The lock nearby will appear on the phone screen, Click "+"
- 7) Re-name the lock
- 8) The lock added successfully

AUSLOCK users can register the account by mobile phone and Email which currently support 200 countries and regions on the world. The verification code will be sent to user's mobile phone or email, and the registration will be successful after the verification.

3.3. Add locks

Auslock supports multiple types of lock devices. The lock needs to be added by the app after entering the add mode. Generally, a lock that has not been added, as long as the lock keyboard is touched, it will enter the add mode. The default password is 123456 if not added by the phone

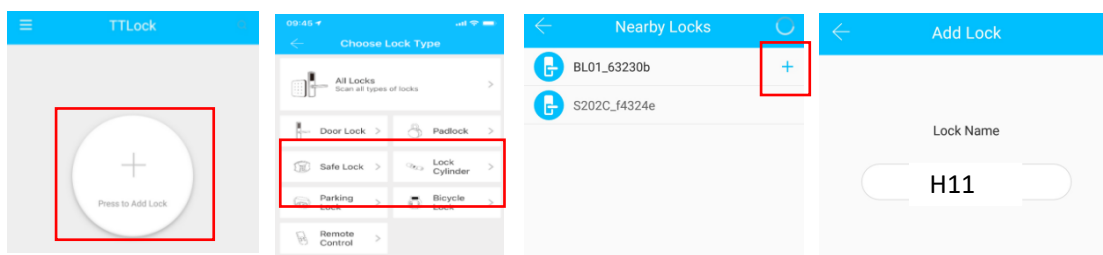

3.4. User Management

3.4.1. Bluetooth management

Make sure there is no problem with Bluetooth communication. After connecting the phone to the door lock as above, Click "  "to unlock.(the phone is within 5meters from the door lock)

3.4.2. Setting Passcode

Passcodes are also a way to unlock. After entering the passcode on the locked keyboard, press the unlock button in the lower right corner to unlock. Passcodes are divided into permanent, time-limited, single, clear, cycle, and custom. (You can share the Passcode to other user via WeChat、SMS、Email、Messenger、WhatsApp)

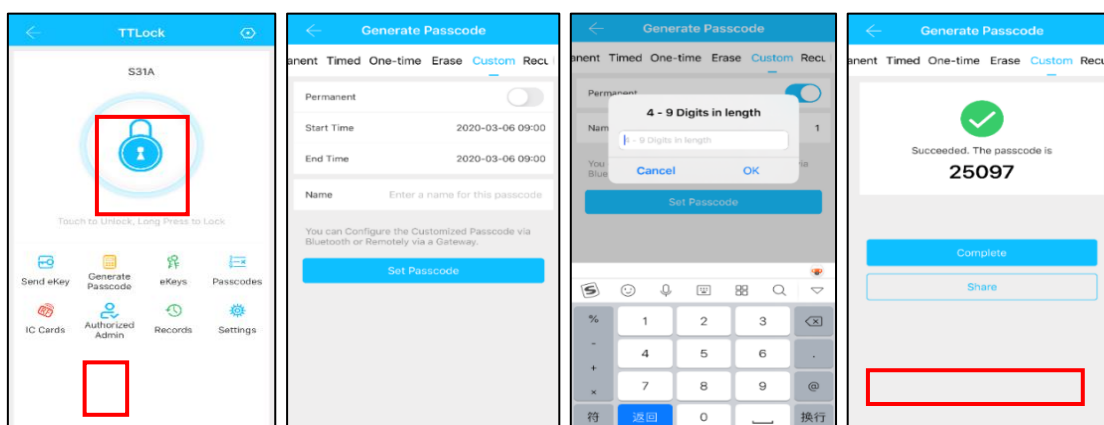

3.4.3. Send e-Key

Click on the "  " as shown in figure, you can send the eKey to other users of Auslock to authorize the unlock(the receiver must be download the APP and set up an account)→ Select e-key format (Timed, permanent, One-time, Recurring) → Enter recipient's account of Auslock ,set the name and effective time of the eKey, Can choose to allow remote unlocking or disallowing, authorized administrator or not authorized, as shown in figure →Send→The recipient's account has Bluetooth unlock permission

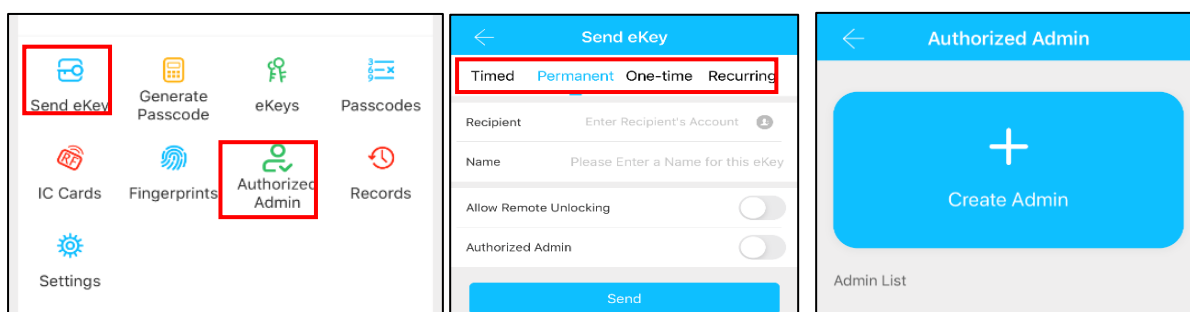

3.4.4. Add card

Supports opening doors through various IC cards. Before an IC card is used to open the door, it needs to be added first. The adding process needs to be performed by the app beside the lock. The validity period of the IC can be set, it can be permanent, or it can be limited in time.

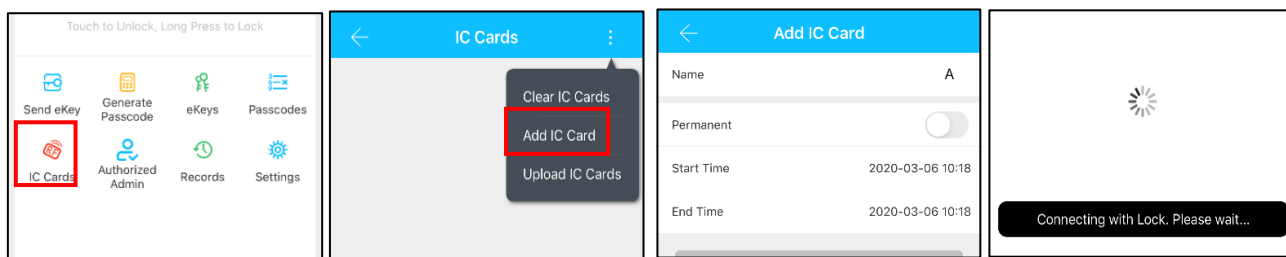

3.4.5. Add fingerprint

The premise that a fingerprint can be used to open a door is that it needs to be added first. The adding process needs to be performed by the APP beside the lock. The fingerprint expiration data can be set, it can be permanent, or it can be limited. After setting, you can modify its validity period.

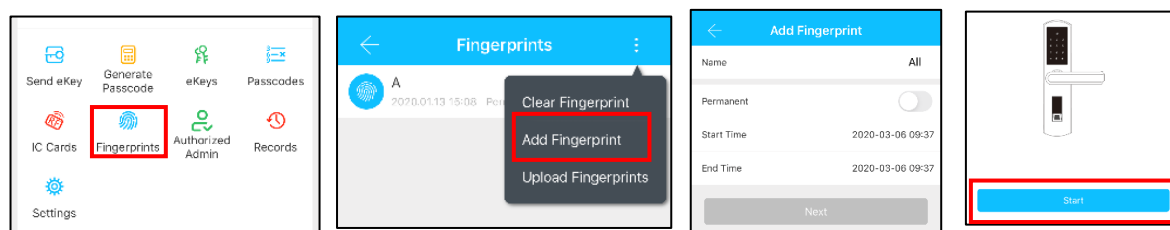

3.4.6. e-Key management

Click "eKeys". The manager can delete ekey, reset ekey, send and adjust the ekey, meanwhile he can search lock record.

3.4.7. Passcode management

Click "Passcodes". All generated passwords can be viewed and managed in the password management module. This includes a password change, password deletion, password reset, and password unlock record.

3.4.8. Unlock records

Click "Records". You can query your unlock record as shown in figure

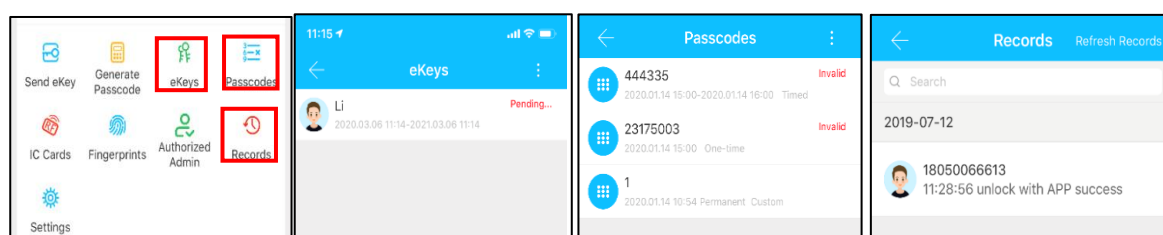

3.5. Gateway management(Optional)

The Auslock is directly connected via Bluetooth, that is why it is not attacked by the network. The gateway is a bridge between smart locks and home WIFI networks. Through the gateway, the user can remotely view and calibrate the lock clock, read the unlock record. Meanwhile, it can remotely delete and modify the password.

3.5.1. Add Gateway

Light Status



When the gateway is powered on:

- Light flashes alternately in red and blue: Stand-by mode, ready for pairing
- Blue light: Working mode
- Red light: Network failure

4. Select [G2]



5. Plug in the gateway and power it on, while the light flashes alternately in red and blue



6. Press "+" sign



Pair the Gateway with APP

1. Activate the APP

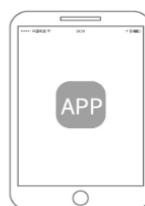

2. Press "≡"

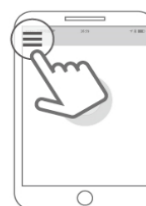

3. Select [Gateway]

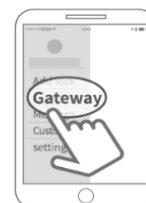

7. Add Gateway



8. Select the network and fill in the password



9. Add complete

⚠ Notice: If times out, please power off and try it again.

3.6. Electronic Locking Button



1.If you want to have the Electronic Locking function, first turn on "privacy lock" on the app 2. When the button is in the red state, it is in the locked state and can only be unlocked through the administrator app or mechanical key.

4.FAQ

Introduction Installation Operation F&Q Appendix	1) How to read operation records?	In the Records of the main interface. .
	2) Why can't I unlock it after open the passage mode	You need to perform an unlock verification in any method, than the passage mode will take effect.
	3) What is the purpose of Auto Lock	You can set how long to lock after unlocking
	4) After installation, touch sensing keyboard, screen no respond	<p>a) In this case, first check that the positive and negative electrodes of the battery have been installed upside down, whether the battery has enough power</p> <p>b) Remove the back panel and see if it's connected.</p> <p>c) To eliminate the above situation, you need to remove the lock ,check whether the wires of the lock body are squeezed, and the re-wire.</p>
	5) Unable to register fingerprint	<p>Check the fingers for dirt or wear, check the fingerprint head on the lock for dirt and oil stains, etc.</p> <p>Check to see if the fingerprint is working properly(Press to see if there is any responds.</p>
	6) What is the reason why the smart lock consumes fast power?	<p>a) Large standby power consumption</p> <p>b) Short circuit</p>
	7) There is no response to pressing the handle on outside the door, and there is unlock normally on inside the door, but the verification is normal, and the motor is normal.	It may be the triangle direction on the clutch was error, please check correction.
	8) How many times will the password be locked? How long is it locked?	Enter the wrong password more than 5 times in a row, the keyboard is locked for 5 minus, Other ways to can open the door



Lock Better. Live Better.

Guarantee

(To Validate warranty, below details must be filled by customer and emailed back to Auslock within 30 days or else Auslock may not offer full services (au@auslock.net))

Customer Full Name : _____

Customer Contact No. : _____

Place of Purchase (store) : _____

Purchase Date : _____

Product Name : _____

Product Model : _____

Note:

- 1) Please keep this card so that you can use it when you need warranty service.
- 2) We provide you with a one-year warranty from the date of purchase. Visit auslock.net for Further Details.
- 3) This warranty service is valid for customers in any country in the world.